

Plugs and socket outlets

Flanged sockets conforming to Danish, English and Swiss system

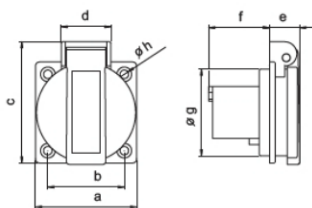

Socket outlet Danish system

	16 Amp
Poles	2P + E
a	50
b	38
c	60
d	24,5
e	15
f	30
g	43
h	4,2
Connection type:	Screwed contact
Weight [g]	42

- with screw terminals
- housing material: PA6
- contacts: nickel-plated contacts

IP44 splashproof

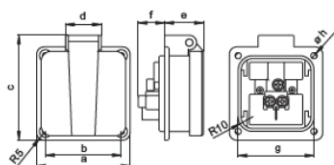

Socket outlet English version

	13 Amp	13 Amp
Poles	2P + E	2P + E
a	64	50
b	52	38
c	72	64
d	25	25
e	26,5	18
f	18	22
g	52	35
h	4,2	4,5
Connection type:	Screwed contact	
Weight [g]	67	50

- with screw terminals
- housing material: PA6

IP54 splashproof

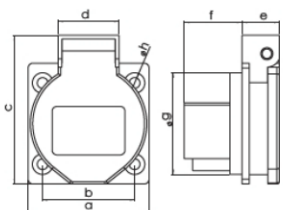

Socket outlet Swiss version T13

	10 Amp
Poles	2P + E
a	50
b	38
c	62
d	29
e	15
f	23
g	42
h	4,2
Connection type:	Screwed contact
Weight [g]	42

- with screw terminals
- housing material: PA6
- contacts: nickel-plated contacts

IP54 splashproof

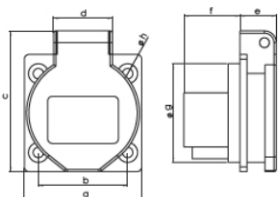

Socket outlet Swiss version T23

	16 Amp
Poles	2P + E
a	50
b	38
c	60
d	25
e	15
f	24
g	42
h	4,2
Connection type:	Screwed contact
Weight [g]	42

- with screw terminals
- housing material: PA6
- contacts: nickel-plated contacts

IP54 splashproof

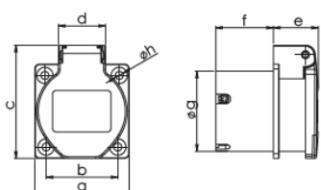

Socket outlet Swiss version T25

	16 Amp
Poles	3L + N + PE
a	50
b	38
c	60
d	25
e	24
f	31
g	43
h	4,2
Connection type:	Screwed contact
Weight [g]	64

- with screw terminals
- housing material: PA6
- contacts: nickel-plated contacts
- 250V/400V~ 16A

IP54 splashproof



250V~
50/60Hz

400V~
50/60Hz

PCE

Amp.	Poles	pack. unit	Abbreviations/Types	Cat.No.	Cat.No.		
16	3	100	rear connection Flange: 50 x 50	1030-0b	blue		
16	3	100	rear connection Flange: 50 x 50	1030-0s	black		
13	3	100	side connection Flange: 64 x 64	1020-0s	black		
13	3	100	side connection Flange: 50 x 50	1020-5s	black		
10	3	100	rear connection Flange: 50 x 50	1013-0b	blue		
10	3	100	rear connection Flange: 50 x 50	1013-0b	blue		
16	3	100	side connection Flange: 50 x 50	1023-0bs	blue		
16	3	100	side connection Flange: 50 x 50	1023-0bs	blue		
16	5	100	rear connection Flange: 50 x 50	1025-0r	red		
16	5	100	rear connection Flange: 50 x 50	1025-0r	red		