

Multiple-sockets outlet



T-Connect 2-way connector with CEE plug

- Fittings:**
- 1 CEE-plug 16A 3p 6h
 - 2 CEE-sockets 16A 3p 6h

IP44 splashproof
IP67 watertight

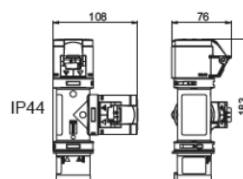

	Cat. No.
IP44	94325103*
IP67	94326103*
pack. unit: 10	



T-Connect 2-way connector with cable entry

- Fittings:**
- 1 cable entry with cable gland (terminal max. 3x2,5mm²)
 - 2 CEE-sockets 16A 3p 6h outlet

IP44 splashproof
IP67 watertight

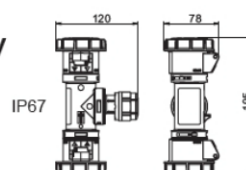

IP44	94325102
IP67	94326102
pack. unit: 10	



Multiple-socket outlet

- nickel plated contacts
- also available in 110V

IP44 splashproof
IP67 watertight

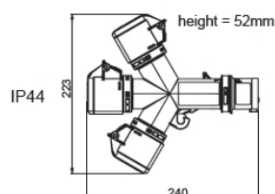

Entry:	1 CEE-plug 16A 3p 230V
Outlet:	3 CEE-sockets 16A 3p 230V
IP44	9432000*
IP67	9432001*



Multiple-socket outlet

- nickel plated contacts
- also available in 110V
- available also with Belg./French, Danish and British sockets

IP44 splashproof

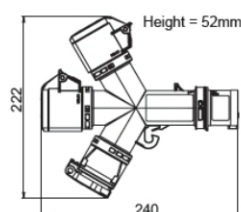

Entry:	1 CEE-plug 16A 3p 230V
Outlet:	2 CEE-sockets 16A 3p 230V 1 safety socket 16A 250V
IP44	9432004*



Multiple-socket outlet

- nickel plated contacts
- also available in 110V

IP44 splashproof
IP67 watertight

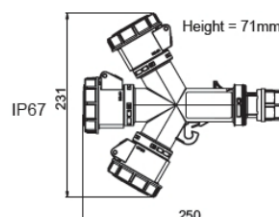

Entry:	1 Twist-cable gland prewired on terminals
Outlet:	3 CEE-sockets 16A 3p 230V
IP44	9432006
IP67	9432007



Multiple-socket outlet

- nickel plated contacts
- also available in 110V

IP44 splashproof
IP67 watertight

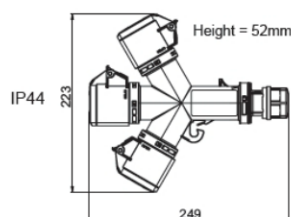

Entry:	1,5m cable with plug 16A 3p 230V
Outlet:	3 CEE-sockets 16A 3p 230V
IP44	9432002
IP67	9432003

* Export version (Usage in Austria and Germany not allowed!) - other versions on request