

Phase inverters

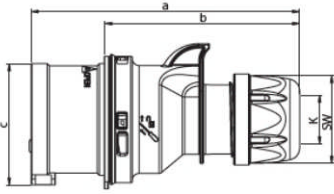

Shark Phase inverter plug IP44

	16 Amp		32 Amp	
	4	5	4	5
a	128	134	150	155
b	92	98	104	109
c	53	61	63	70
K_cable Ø [mm]	6-15	8-16	11,5-20	11,5-22
Connection type:	Screw terminal			
Wire flexible class 5 or 6 [mm ²]	1-2,5		2,5-6	
Contact screws [Ncm]	100 Ncm		110 Ncm	
SW	42	42	50	50
Weight [g]	131	154	204	236

- with screw terminals
- housing material: PA6
- contacts: nickel-plated contacts

IP44 splashproof

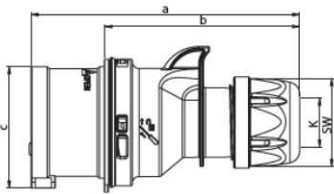

Turbo Shark Phase inverter plug IP44

	16 Amp		32 Amp	
		5		5
a		134		155
b		98		109
c		61		70
K_cable Ø [mm]		8-16		11,5-22
Connection type:	Screw terminal and screwless terminal			
Wire flexible class 5 or 6 [mm ²]	1-2,5		2,5-6	
Contact screws [Ncm]	100 Ncm		110 Ncm	
SW		42		50
Weight [g]		156		237

- L1, N, PE = screwless connection terminals
- L2, L3 = screw terminals
- housing material: PA6
- contacts: nickel-plated contacts

IP44 splashproof

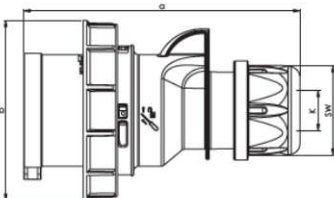

Shark Phase inverter plug IP67

	16 Amp		32 Amp	
	4	5	4	5
a	128	134	150	155
b	79	87	93	100
c				
K_cable Ø [mm]	6-15	8-16	11,5-20	11,5-22
Connection type:	Screw terminal			
Wire flexible class 5 or 6 [mm ²]	1-2,5		2,5-6	
Contact screws [Ncm]	100 Ncm		110 Ncm	
SW	42	42	50	50
Weight [g]	153	183	245	280

- with screw terminals
- housing material: PA6
- contacts: nickel-plated contacts

IP67 watertight

230V~ 50/60Hz 4p=9h	400V~ 50/60Hz 4p+5p=6h
Cat.No.	Cat.No.

Amp.	Poles	pack. unit
16	4	10
16	5	10
32	4	10
32	5	10

7014-9	7014-6 7015-6
7024-9	7024-6 7025-6



7015-6



16	5	10
32	5	10

	7015-6TT 7025-6TT
--	--------------------------



7015-6TT

16	4	10
16	5	10
32	4	10
32	5	10

70142-9	70142-6 70152-6
70242-9	70242-6 70252-6



70252-6

Functional principle: Phase inverter

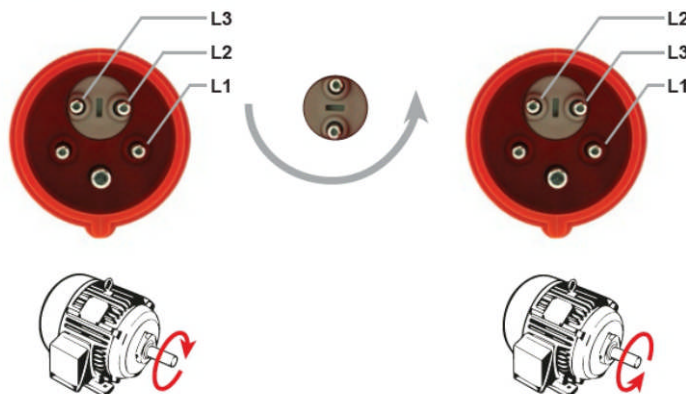

Phase inverters

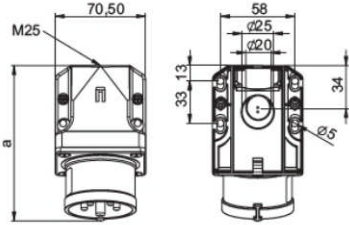

b=height
angle=15°

Phase inverter - Wall mounted plug IP44

	16 Amp		32 Amp	
Poles		5	4	5
a		122	131	132
b		79	85	85
M		25	25	25
Connection type:	Screw terminal			
Wire flexible class 5 or 6 [mm ²]	1-2,5		2,5-6	
Contact screws [Ncm]	100 Ncm		110 Ncm	
Weight [g]		205	234	255

- with screw terminals
- housing material: PA6
- contacts: nickel-plated contacts
- top and rear entry
- incl. threaded cable grommet

IP44 splashproof

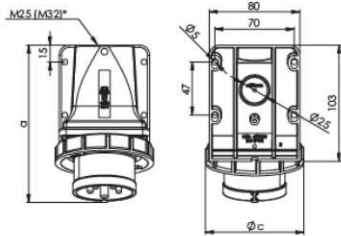

b=height
angle=15°

Phase inverter - Wall mounted plug IP67

	16 Amp		32 Amp	
Poles		5	4	5
a		140	153	152
b		100	104	102
c		71	93	100
M*		25	25	25
Connection type:	Screw terminal			
Wire flexible class 5 or 6 [mm ²]	1-2,5		2,5-6	
Contact screws [Ncm]	100 Ncm		110 Ncm	
Weight [g]		241	276	307

- with screw terminals
- housing material: PA6
- contacts: nickel-plated contacts
- top and rear entry
- incl. threaded bung

IP67 watertight

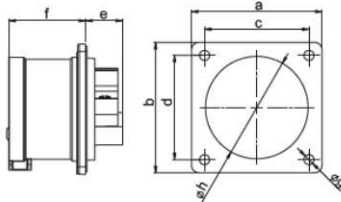

Phase inverter - Flanged plug straight IP44

	16 Amp		32 Amp	
Pole s		5	4	5
Flange				
a x b		70	70	70
Fixing center				
c x d		56	56	56
e		20	21	21
f		42	51	51
g		5,5	5,5	5,5
h		55	55	55
Connection type:	Screw terminal			
Wire flexible class 5 or 6 [mm ²]	1-2,5		2,5-6	
Contact screws [Ncm]	100 Ncm		110 Ncm	
Weight [g]		118	146	167

- with screw terminals
- housing material: PA6
- contacts: nickel-plated contacts
- According to EN 60309:
For correct use a locking device has to be provided (see page 32)

IP44 splashproof

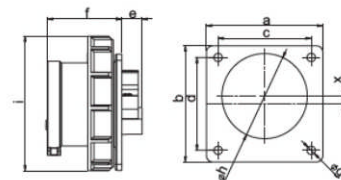

Phase inverter - Flanged plug straight IP67

	16 Amp		32 Amp	
Poles		5	4	5
Flange				
a x b		75	75	75
Fixing Center				
c x d		60	60	60
e		13	15	14
f		48	58	58
g		5,5	5,5	5,5
h		55	55	55
h		87	93	100
x		5	4,5	0
Connection type:	Screw terminal			
Wire flexible class 5 or 6 [mm ²]	1-2,5		2,5-6	
Contact screws [Ncm]	100 Ncm		110 Ncm	
Weight [g]		150	185	215

- with screw terminals
- housing material: PA6
- contacts: nickel-plated contacts
- According to EN 60309:
For correct use a locking device has to be provided (see page 32)
- for 16A 5p and 32 5p the plug is placed off centered for keeping the standards

IP67 watertight

230V~

50/60Hz
4p=9h

400V~

50/60Hz
4p+5p=6h

Amp.
Poles
pack. unit

Cat.No.

Cat.No.

16	5	10
16	5	10
32	4	10
32	4	10
32	5	10
32	5	10

	7715-6
	7715-6d
7724-9	7724-6
7724-9d	7724-6d
	7725-6
	7725-6d

with cap

with cap

with cap



7715-6

16	5	5
32	4	5
32	5	5

	77152-6k
77242-9k	77242-6k
	77252-6k



77152-6k

flange 70 x 70 - fixing center 56 x 56		
16	5	10
32	4	10
32	5	10

	8615-6
8624-9	8624-6
	8625-6



8624-6

flange 75 x 75 - fixing center 60 x 60		
16	5	10
32	4	10
32	5	10

	86152-6
86242-9	86242-6
	86252-6



86152-6



Phase inverters

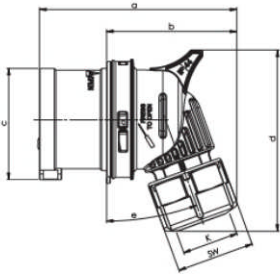

Twist Phase inverter - Angled plug IP44

	16 Amp		32 Amp	
	4	5	4	5
Poles	4	5	4	5
a	98	108	127	135
b	62	71	82	90
c	53	61	63	70
d	87	99	111	114
e [°]	15	20	25	25
K_cable Ø [mm]	6-15	8-16	11,5-20	11,5-22
Connection type:	Screw terminal			
Wire flexible class 5 or 6 [mm ²]	1-2,5		2,5-6	
Contact screws [Ncm]	100 Ncm		110 Ncm	
SW	38	42	50	50
Weight [g]	128	150	181	237

- with screw terminals
- housing material
16/4: PA6
16/5, 32/4, 32/5: PC/ABS
- contacts: nickel-plated contacts

IP44 splashproof

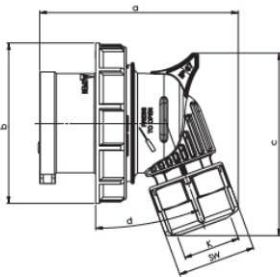

Twist Phase inverter - Angled plug IP67

	16 Amp		32 Amp	
	4	5	4	5
Poles	4	5	4	5
a	98	108	127	135
b	62	71	93	90
c	53	61	111	70
d	15	20	25	25
K_cable Ø [mm]	6-15	8-16	11,5-20	11,5-22
Connection type:	Screw terminal			
Wire flexible class 5 or 6 [mm ²]	1-2,5		2,5-6	
Contact screws [Ncm]	100 Ncm		110 Ncm	
SW	38	42	50	50
Weight [g]	152	180	188	281

- with screw terminals
- housing material
16/4: PA6
16/5, 32/4, 32/5: PC/ABS
- contacts: nickel-plated contacts

IP67 watertight

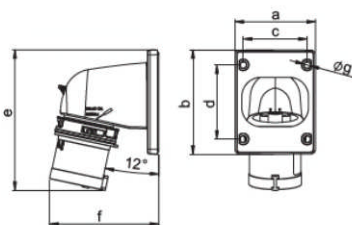

Twist Phase inverter - Flanged plug angled IP44

	16 Amp		32 Amp	
	4	5	4	5
Poles	4	5	4	5
a	66	90	90	90
b	86	100	100	100
c	53	77	77	77
d	61	85	85	85
e	117	153	163	164
f	93	98	100	103
g	5	5	5	5
Connection type:	Screw terminal			
Wire flexible class 5 or 6 [mm ²]	1-2,5		2,5-6	
Contact screws [Ncm]	100 Ncm		110 Ncm	
Weight [g]	147	190	222	249

- with screw terminals
- housing material: PC/ABS
- contacts: nickel-plated contacts

IP44 splashproof

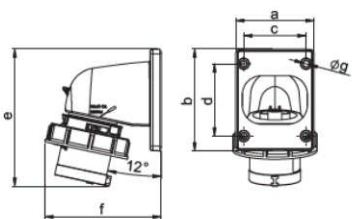

Twist Phase inverter - Flanged plug angled IP67

	16 Amp		32 Amp	
	4	5	4	5
Poles	4	5	4	5
a	66	90	90	90
b	86	100	100	100
c	53	77	77	77
d	61	85	85	85
e	117	153	163	164
f	103	107	110	114
g	5	5	5	5
Connection type:	Screw terminal			
Wire flexible class 5 or 6 [mm ²]	1-2,5		2,5-6	
Contact screws [Ncm]	100 Ncm		110 Ncm	
Weight [g]	171	225	261	297

- with screw terminals
- housing material: PC/ABS
- contacts: nickel-plated contacts

IP67 watertight

230V~
50/60Hz
4p=9h

400V~
50/60Hz
4p+5p=6h

Amp.	Poles	pack. unit
16	4	10
16	5	10
32	4	10
32	5	10

Cat.No.	Cat.No.
7414-9	7414-6
	7415-6
7424-9	7424-6
	7425-6



7414-6



16	4	10
16	5	10
32	4	10
32	5	10

74142-9	74142-6
	74152-6
	74242-6
	74252-6



74142-6

16	4	10
16	5	5
32	4	5
32	5	5

77814-9	77814-6
	77815-6
77824-9	77824-6
	77825-6



77814-6

16	4	10
16	5	5
32	4	5
32	5	5

778142-9	778142-6
	778152-6
778242-9	778242-6
	778252-6



778152-6